

# Two-Way Ball Valve Series 11-S

DN ½" to 4"

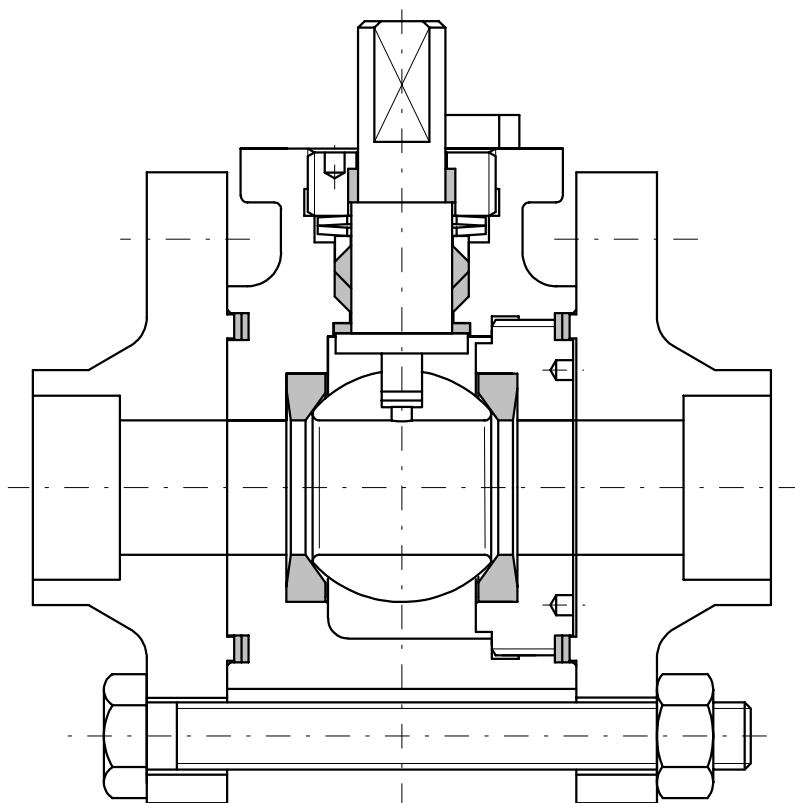

## Description:

This PERRIN ball valve design features a three piece body and a floating, seat supported ball. The stem packing is spring loaded the seat rings with pressure relief warranty are pre-loaded. Through dismantling the central piece the interior parts could be exchanged comfortably. The pipe remains stable.

The actuator mounting flange corresponds to the NAMUR recommendations with dimensions to DIN/ISO 5211.

Stem extensions, locking devices and actuators with accessoires can be field mounted at any time.

The ball valve is extruded in antistatic-design, with anti blowout proof stem and, as desired, "fire-safe" tested. The stem packing has examined TA-Luft.

## Range of application:

DN ½" to 4"	PN ANSI Cl. 150/300	Temperature -40°C to 200°C
----------------	------------------------	-------------------------------

## 1.0 Main parts

item	designation
1	body
2	body end connection
4	retainer ring
5	ball
6	stem
8	gland washer
10	threaded ring
16	plate spring
21	seat ring
23	body gasket
24	stem packing
25	bearing ring
26	bearing ring
28	screw
32	nut

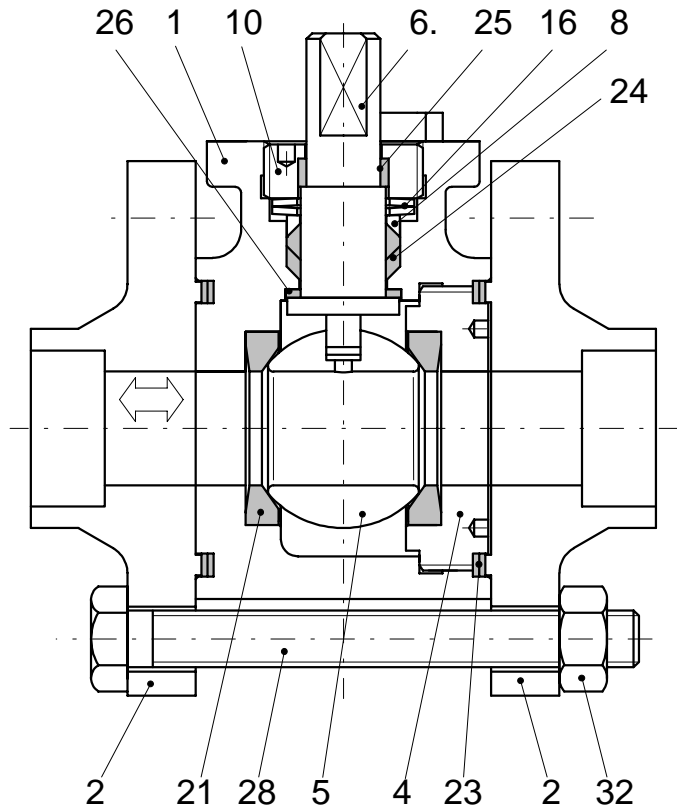

fig. 1  
ball valve, series 11-S

Technical modifications are reserved.

## 2.0 Materials

item	designation	temperatures:	
		-40°C to 200°C <sup>1)</sup>	-10°C to 200°C <sup>1)</sup>
1	body	1.4571 / 1.4408	1.0460 / 1.0619
2	body end connection		
4	retainer ring	1.4571	1.4571
5	ball	1.4571 / 1.4404 / 1.4408	1.4571 / 1.4404 / 1.4408
6	stem	1.4571	1.4571
8	gland washer		
10	threaded ring		
16	plate spring	1.4568	1.8159
21	seat ring	PTFE - TFM	PTFE - TFM
23	body gasket		
24	stem packing	PTFE - Graphite	PTFE - Graphite
25-26	bearing ring	PTFE - 25% Glass	PTFE - 25% Glass
28	screw	A 2-70	A 2-70
32	nut	A 2	A 2

1) Materials for lower/higher temperatures on request..

### 3.0 Technical data

#### 3.1 Nominal size / Dimensions / Connections / Flow / Weights

Nominal size (DN)	pipe	valve- port	dimensions									flow $K_{V100}$ [m <sup>3</sup> /h] $\Delta p=$ 1bar	face to face		connections	weight [kg]		actuator- connection DIN/ISO 5211
			H1	H2	H3	H4	$\varnothing D$	$\varnothing d$	ZF	R	t		L	LM				
full port	15	15	47	50	19	95	22	13	10	180	10	20	110	52	welding ends: butt weld and socket weld end acc. to DIN 3239 T2 Reihe 5 for ISO pipes, threads: acc. to DIN 259 or NPT		3,5	F 05
	20	20	47	50	19	95	27,5	13	10	180	13	38	110	52			3,5	F 05
	25	25	47	62	19	106	34,5	13	10	180	13	65	110	52			3,8	F 05
	32	32	64	81	23	126	43	17	12	300	13	117	140	75			4,9	F 07
	40	40	64	81	23	126	49	17	12	300	16	196	140	75			6	F 07
	50	50	72	89	23	134	61,5	17	12	300	16	325	160	90			7,8	F 07
	65	65	88	99	23	144	77	17	12	300	16	598	180	105			9,9	F 07
	80	80	104	125	28	153	90	27	18	450	16	960	200	125			17	F 10
reduced port	20	15	47	50	19	95	27,5	13	10	180	13	20	110	52		3,4	F 05	
	25	20	47	50	19	95	34,5	13	10	180	13	38	110	52		3,8	F 05	
	32	25	47	62	19	106	43	13	10	180	13	65	110	52		4,9	F 05	
	40	32	64	81	23	126	49	17	12	300	13	117	140	75		6	F 07	
	50	40	64	81	23	126	61,5	17	12	300	16	196	140	75		7,8	F 07	
	65	50	72	89	23	134	77	17	12	300	16	325	160	90		9,9	F 07	
	80	65	88	99	23	144	90	17	12	300	16	598	180	105		17	F 07	
	100	80	104	125	28	153	115,5	27	18	450	16	960	200	125		19	F 10	

dimensions in mm

Technical modifications are reserved.

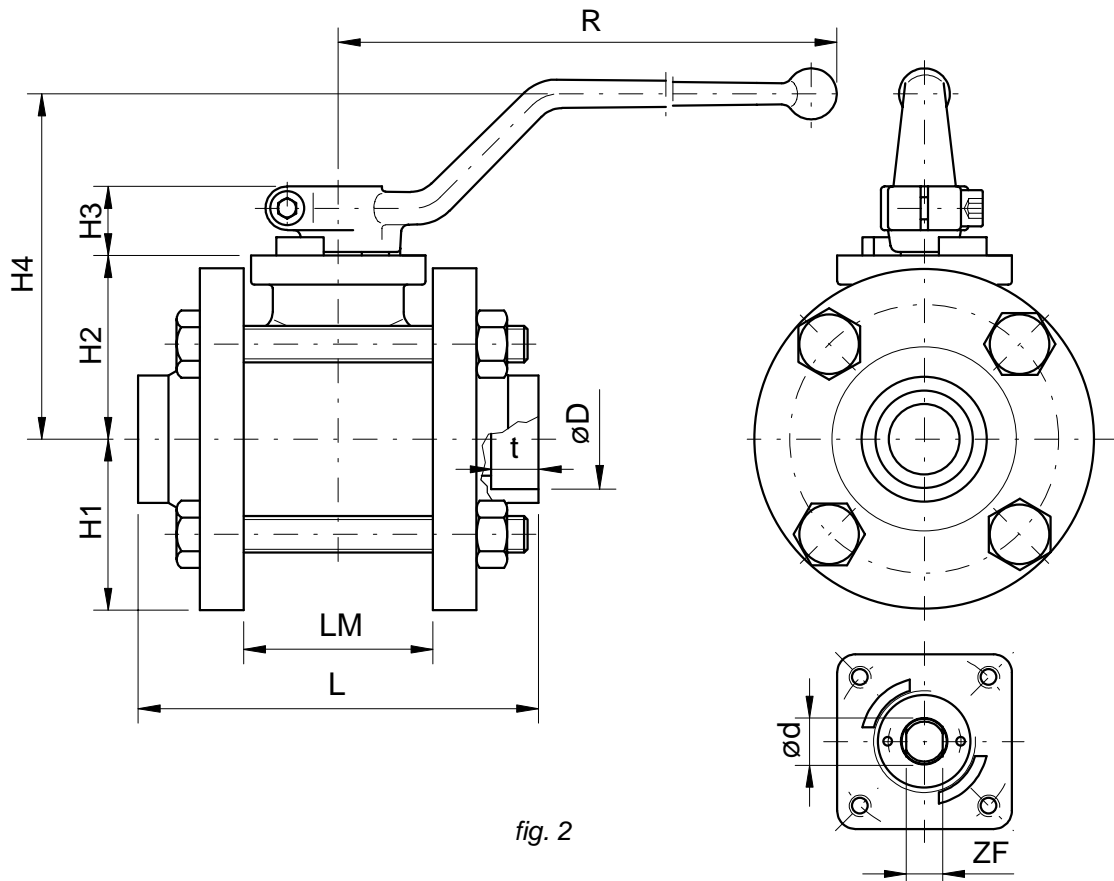

fig. 2

### 3.2 Special features

profit:

- ready to take actuator
- minimal abrasion
- standard connections
- constant torque
- minimal maintenance

design:

- three piece body
- removable midsection
- floating ball
- no welds
- anti blowout proof stem
- live loaded stem packing